

NEVOBAHN® - 2+2 GEO MIT INTEGRIERTER DRAINAGESCHICHT

Nevobahn® - 2+2 GEO with drainage textile



The damage and inconvenience caused by water infiltration through basement walls - due to heavy rains, thawing snow, etc. - are nightmares for property owners. Various sheet products and thermal insulation systems have been offered in the past as answers to these problems. Now, with the introduction of NEVOBAHN® - 2+2 GEO with integrated geotextile layer, a new era has begun in protection of external insulation over foundation walls.

- Integrated geotextile layer, EN ISO 13252-compliant, with outstanding water permeability (110 l/m²/s according to EN ISO 11058) for fast drainage.
- Structural waterproofing sheet in compliance with DIN EN 13967. Additional design feature: air gap on rear side.
- Extremely high compressive strength of 370 kN/m² provided by innovative 2+2 positive-negative dimple pattern.
- Safe for drinking water, impervious to root penetration, reto-proof, outstanding chemical resistance.
- 10 cm geotextile overhang extends over the geotextile of the neighbouring sheet section. Double overlap = double reliability.
- Equally well suited for new construction or retrofit installation to satisfy ever stricter energy efficiency regulations.
- When properly installed NEVOBAHN® - 2+2 GEO with integrated geotextile layer protects against infiltration by hazardous gas emissions from soil, including radon gas.
- Low transport costs, shipped as compact, low-volume rolls.

Item-No.	Width m	Length m	Quantity of coil	m ² / Pallet
NBD22020	2,20	20	8	352

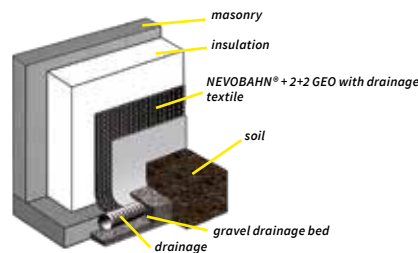

NEVOBAHN® - 2+2 GEO PLUS MIT INTEGRIERTER DRAINAGESCHICHT UND GLEITFOLIE

Nevobahn® - 2+2 GEO PLUS with drainage textile and sliding film



Look at item „NEVOBAHN® - 2+2 GEO“. This article is with sliding film.

Item-No.	Width m	Length m	Quantity of coil	m ² / Pallet
NBDG22020	2,20	20	8	352

