



PRODUCTS

CONSTRUCTION FILM & DIMPLED SHEET

**TEST CERTIFICATION
ON REQUEST**

Vapour Barrier Sheets
white or blue



PE-DAMPFBREMSFOLIE

The PE vapour barrier film is a specially manufactured film with high vapour diffusion resistance. The PE-Dampfbremsfolie will be fixed inside of the building components to prevent an air change from inside and outside. A result is the prevention of creation of condensation.

Item-No.	Strength mm	Width m	Length m	Quantity of coil	m ² /Pallet
FDB16...	0,160	4	25	75	7.500
FDB20...	0,200	4	25	52	5.200
FDB25...	0,250	4	25	46	4.600
FDB45...	0,450	4	25	27	2.700

Other dimension (width/length) available on request.

- tested according DIN 13984
- fire classification E
- not permeable



PE-BAUFOLIE - TRANSPARENT

The transparent construction film is made of low-density 100% polyethylene. Transparent with no self-coloration.

PE-Construction Film
transparent



Item-No.	Strength mm	Width m	Length m	Quantity of coil	m ² /Pallet
FNS030...	0,030	2	100	100	20.000
FNS040...	0,040	2	100	10	20.000
FNS040...	0,040	4	100	75	30.000
FNS050...	0,050	2	50	100	10.000
FNS050...	0,050	4	50	75	15.000
FNS060...	0,060	2	50	100	10.000
FNS060...	0,060	4	50	75	15.000
FNS100...	0,100	2	50	94	9.400
FNS100...	0,100	4	50	60	12.000
FNS120...	0,120	2	50	75	7.500
FNS120...	0,120	4	50	46	9.200
FNS150...	0,150	2	50	75	7.500
FNS150...	0,150	4	50	44	8.800
FNS200...	0,200	2	50	60	6.000
FNS200...	0,200	4	50	33	6.600
FNS300...	0,300	4	25	44	4.400
FNS400...	0,400	4	25	27	2.700
FNS500...	0,500	4	25	27	2.700

Other dimension (width/length) available on request.



PE-BAUFOLIE - TRANSLUZENT

Robust Eco-film. Based on different coloring. It is possible that the film can have minimal variation of colours.

Item-No.	Strength mm	Width m	Length m	Quantity of coil	m ² /Pallet
FTS050...	0,050	2	50	100	10.000
FTS050...	0,050	4	50	75	15.000
FTS060...	0,060	2	50	100	10.000
FTS060...	0,060	4	50	75	15.000
FTS100...	0,100	2	50	94	9.400
FTS100...	0,100	4	50	60	12.000
FTS120...	0,120	2	50	75	7.500
FTS120...	0,120	4	50	46	9.200
FTS150...	0,150	2	50	75	7.500
FTS150...	0,150	4	50	44	8.800
FTS200...	0,200	2	50	60	6.000
FTS200...	0,200	4	50	33	6.600
FTS300...	0,300	4	25	44	4.400
FTS400...	0,400	4	25	27	2.700
FTS500...	0,500	4	25	27	2.700

Other dimension (width/length) available on request.



PE-Construction Film translucent



PE-BAUFOLIE - OPAK

100% recycled material. Depending on origin: opaque / minimal colored.

Item-No.	Strength mm	Width m	Length m	Quantity of coil	m ² /Pallet
FOS100...	0,100	2	50	4	9.400
FOS100...	0,100	4	50	60	12.000
FOS120...	0,120	2	50	75	7.500
FOS120...	0,120	4	50	46	9.200
FOS150...	0,150	2	50	75	7.500
FOS150...	0,150	4	50	44	8.800
FOS200...	0,200	2	50	60	6.000
FOS200...	0,200	4	50	33	6.600
FOS300...	0,300	4	25	44	4.400
FOS400...	0,400	4	25	27	2.700
FOS500...	0,500	4	25	27	2.700

Other dimension (width/length) available on request.



PE-Construction Film opaque



**TEST CERTIFICATION
ON REQUEST**

Nevobahn
Standard



NEVOBAHN - STANDARD

NEVOBAHN Standard is very durable - it is rot-proof and impervious. The NEVOBAHN Standard is specifically for foundation wall protection and blinding beds. Naturally the NEVOBAHN are proved acc. DIN-guideline - following test certifications:

- Determination of resistance to water penetration acc. to DIN EN 1928
- Determination of water tightness acc. to DIN EN 13967
- Determination of water vapour transmission rate acc. to DIN EN ISO 15106-3
- Determination of resistance to tearing (nail shank) acc. to DIN EN 12310-1
- Test report on compressive strength

Item-No.	Width m	Length m	Quantity of coil	m ² / Pallet
NBS05020SP60	0,5	20	60	600
NBS10020SP30	1,0	20	30	600
NBS15020SP15	1,5	20	15	450
NBS20020SP15	2,0	20	15	600
NBS25020SP15	2,5	20	15	750
NBS30020SP25	3,0	20	25	1.500
NBS40020SP20	4,0	20	20	1.600

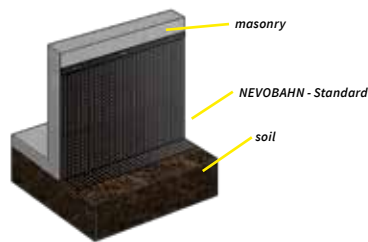

Developed for foundation wall protection
provides ventilation over the wall surface covered

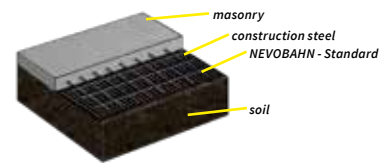

Developed for blinding beds
cost- and timesaving

Nevobahn with
sliding film



NEVOBAHN - MIT GLEITFOLIE

As soon as the refilling material settles, the NEVOBAHN will separate from the sliding film. This sliding area thus created prevents forces of gravitation from damaging the waterproofing coat - in addition the rear-ventilation is ensured.

Item-No.	Width m	Length m	Quantity of coil	m ² / Pallet
NBGF20020	2,0	20	6	240



NEVOBAHN - MIT DRAINAGEVLIES

NEVOBAHN with drainage textile separate the masonry from the soil. The drainage textile secure drainage of groundwater in accordance with required DIN-standards. It's also suitable for application of „perimeter insulation“.

Item-No.	Width m	Length m	Quantity of coil	m ² /Pallet
NBD10020	1,0	20	12	240
NBD20020	2,0	20	6	240
NBD25020	2,5	20	6	300

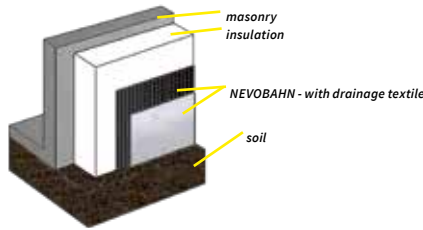

Developed for foundation wall protection

Nevobahn with drainage textile



NEVOBAHN - MIT DRAINAGEVLIES UND GLEITFOLIE

NEVOBAHN with drainage textile and sliding film prevents the waterproofing coat or other materials for waterproofing. This sliding area thus created, guarants a save waterproofing of the percolation water.

Item-No.	Width m	Length m	Quantity of coil	m ² /Pallet
NBDG10020	1,0	20	12	240
NBDG20020	2,0	20	6	240
NBDG25020	2,5	20	6	300

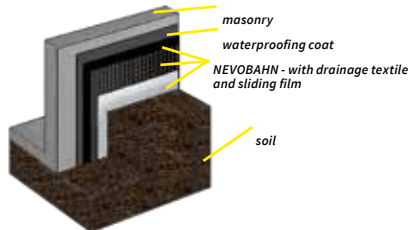

Developed for foundation wall protection

Nevobahn with drainage textile and sliding film



NEVOBAHN with drainage textile and NEVOBAHN with drainage textile and sliding film are certificated by DIN-standards.

- Tests on the resistance to oxidation acc. to DIN EN ISO 13438
- Determination of water flow capacity in the plain acc. to DIN EN ISO 12958
- Determination of the resistance against weathering acc. to DIN EN 12224

NEVOBAHN - 2+2 GEO MIT INTEGRIERTER DRAINAGESCHICHT

Nevobahn - 2+2 GEO with drainage textile



The damage and inconvenience caused by water infiltration through basement walls - due to heavy rains, thawing snow, etc. - are nightmares for property owners. Various sheet products and thermal insulation systems have been offered in the past as answers to these problems. Now, with the introduction of NEVOBAHN - 2+2 GEO with integrated geotextile layer, a new era has begun in protection of external insulation over foundation walls.

- Integrated geotextile layer, EN ISO 13252-compliant, with outstanding water permeability (110 l/m²/s according to EN ISO 11058) for fast drainage.
- Structural waterproofing sheet in compliance with DIN EN 13967. Additional design feature: air gap on rear side.
- Extremely high compressive strength of 370 kN/m² provided by innovative 2+2 positive-negative dimple pattern.
- Safe for drinking water, impervious to root penetration, reto-proof, outstanding chemical resistance.
- 10 cm geotextile overhang extends over the geotextile of the neighbouring sheet section. Double overlap = double reliability.
- Equally well suited for new construction or retrofit installation to satisfy ever stricter energy efficiency regulations.
- When properly installed NEVOBAHN - 2+2 GEO with integrated geotextile layer protects against infiltration by hazardous gas emissions from soil, including radon gas.
- Low transport costs, shipped as compact, low-volume rolls.

Item-No.	Width m	Length m	Quantity of coil	m ² / Pallet
NBD22020	2,20	20	8	352

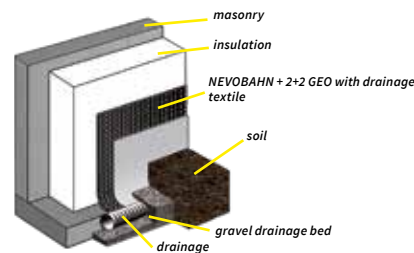

NEVOBAHN - 2+2 GEO PLUS MIT INTEGRIERTER DRAINAGESCHICHT UND GLEITFOLIE

Nevobahn - 2+2 GEO PLUS with drainage textile and sliding film

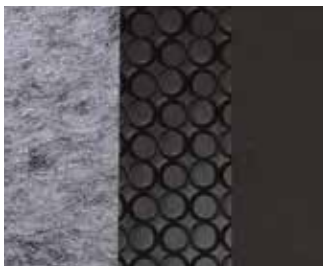

Look at item „NEVOBAHN - 2+2 GEO“. This article is with sliding film.

Item-No.	Width m	Length m	Quantity of coil	m ² / Pallet
NBDG22020	2,20	20	8	352



TEST CERTIFICATION
ON REQUEST

NEVOBAHN - 20MM

NEVOBAHN 20mm provides reliable full-surface drainage in tunnels and other underground structures exposed to heavy groundwater flow. Used as a separating layer, it offers design engineers numerous advantages.

Furthermore the usage is for all areas with a high outstanding drainage capacity f.i. in underground garages or in construction of a stadium. As needed also with textile on naps possible.

Test certificates:

- Determination of burning behavior acc. to DIN EN ISO 11925-2
- Determination of the water flow capacity in the plain acc. to DIN EN ISO 12958
- Determination of static puncture acc. to DIN EN ISO 12236
- Dynamic Perforation test acc. to DIN EN 13433
- Determination of tensile strength acc. to DIN EN ISO 10319
- Determination of resistance to tearing (nail shank) acc. to DIN EN 12310-1
- Water vapour transmission rate acc. to DIN EN ISO 15106-3

Item-No.	Width m	Length m	Quantity of coil	m ² /Pallet
NB2020020	2,0	20	5	200
NB2025020	2,5	20	5	250

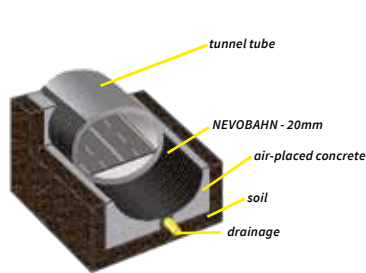
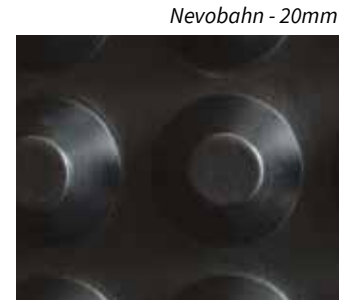

NEVO-RANDABSCHLUSSPROFIL

NEVO-Edge sealing profile provides for a neat border and secure fitting of the installed dimpled sheet. It also prevents foreign material from entering and obstruction the air gap between the dimpled sheet and the underlying wall.

Item-No.	Length m	m/Bundle
NBRP200	2,0	40

NEVO-Edge sealing profile

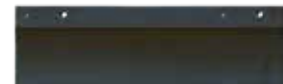

NEVO-MONTAGEKNOPF

NEVO-Assembly button is for anchoring the NEVOBAHN above of the waterproofing. They provide for close-fit, rapid installation over a wide variety of substrates. The fixation is with nails (3,5mm).

Item-No.	Pcs/Bag
NBMK	250

NEVO-Assembly buttons

